



## 12-Cup Coffee Maker



## Instruction Manual

Montgomery Ward Customer Service  
8:00 am to Midnight, Monday through Friday

ITEM: 789019

**wards.com 1•888•557•3848**

**wards.com 1•888•557•3848**



Thank you for purchasing your Chef Tested 12-Cup Coffee Maker by Montgomery Ward. Put through the paces by the experts, we guarantee that it will perform to the highest standard, time after time, with all the convenience, easy cleanup and durability you rely on from Wards.

## Table of Contents

- Important Safeguards ..... 3
- Electrical Safety .....4
- Specifications ..... 4
- Parts & Features..... 5
- How to Use .....6-7
- Cleaning & Care..... 8
- Helpful Hints ..... 9
- Notes ..... 10-11
- Return Information .....12
- Warranty.....13



## Important Safeguards

### READ CAREFULLY BEFORE USING AND SAVE THESE INSTRUCTIONS!

- FOR HOUSEHOLD USE ONLY. DO NOT USE THIS APPLIANCE FOR OTHER THAN ITS INTENDED USE.
- REMOVE all packaging materials before first use.
- Wash all removable parts before first use. See Cleaning & Care.
- A short cord is provided to reduce the hazards resulting from entanglement or tripping. DO NOT drape the cord over a counter or tabletop where it can be pulled on or tripped over. Never wrap the cord tightly around the appliance, as this could cause the cord to fray or break.
- We DO NOT recommend using an extension cord with this appliance. However, if an extension cord is used, the marked electrical rating should be at least as great as the electrical rating of this appliance.
- CLOSE SUPERVISION IS NECESSARY WHEN USING THIS APPLIANCE NEAR CHILDREN.
- A fire may occur if this appliance is used near flammable materials, including curtains, towels, walls, etc. DO NOT place the appliance or its cord on or near a heated surface or in a heated oven.
- This appliance should always be used on a stable, dry, heat-resistant surface.
- DO NOT use near water. DO NOT operate with wet hands.
- DO NOT operate this appliance with an external timer or remote control.
- DO NOT use an accessory or attachment not recommended by the manufacturer, as this may cause injury or damage the appliance.
- Keep hands, hair and clothing away from all hot surfaces.
- Always use oven mitts when handling hot food or appliances. DO NOT attempt to move an appliance when it is hot or has hot contents.
- DO NOT set a hot carafe on a hot or cold surface.
- DO NOT use the carafe on a stovetop.
- DO NOT use a cracked carafe or a carafe having a loose or weakened handle.
- DO NOT use outdoors.
- Turn off and unplug this appliance when not in use.
- THERE ARE NO SERVICEABLE PARTS INSIDE THIS APPLIANCE.
- DO NOT USE AN APPLIANCE WITH A DAMAGED CORD OR PLUG, OR AFTER THE APPLIANCE MALFUNCTIONS OR HAS BEEN DAMAGED IN ANY MANNER.
- Appliances/tools contain valuable materials that can be recycled. Dispose of old appliances/tools using appropriate collection systems in accordance with federal and local regulations.

**This appliance is equipped with a polarized plug in which one prong is wider than the other.** This is a safety feature to reduce the risk of electrical shock. The plug should be attached to the appliance before connecting to an electrical outlet. The plug will fit into a polarized outlet only 1 way. If you are unable to insert the plug into the outlet, try reversing the plug. If it still does not fit, contact a qualified electrician. DO NOT attempt to modify the plug in any way. Montgomery Ward can not accept any liability for damage or injury resulting from failure to observe these safety procedures.

## Specifications

<b>POWER RATING</b>	<b>60Hz, 120V, 900W</b>
<b>CAPACITY</b>	<b>64 oz.</b>
<b>CORD LENGTH</b>	<b>25" +/- 2"</b>
<b>DIMENSIONS</b>	<b>7.25" W x 13.5" H x 9.25" D</b>
<b>MODEL</b>	<b>SLO-146</b>

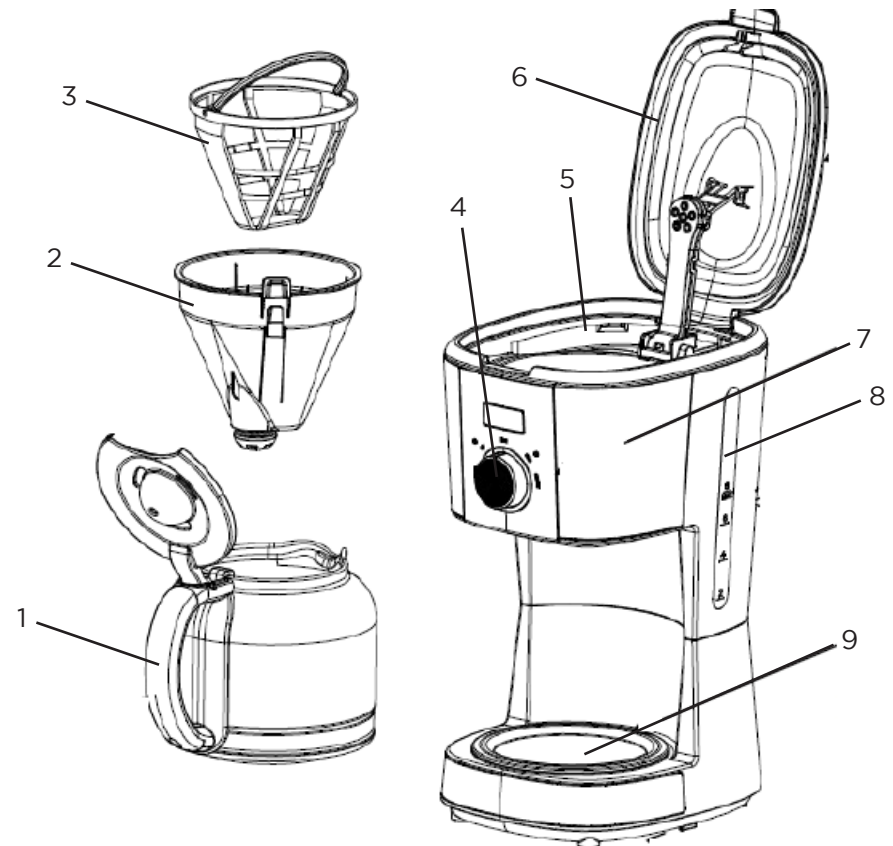

1. Carafe
2. Basket
3. Filter
4. Dial
5. Water Reservoir
6. Lid
7. Housing
8. Water Gauge
9. Heating Plate

**NOTE:** Before the first use, fill the coffee maker reservoir to the 12-cup level and run the brew cycle (see below) with the water only (no coffee). When brewing is done, dispose of the water and repeat.

### SETTING THE CLOCK

1. Plug the power cord into an electrical outlet, the display will flash 12:00.
2. Turn the dial to HOUR and press the dial to set the hour. This is a 12-hour clock, so the time will show AM or PM.
3. Turn the knob to MIN and press the dial to set the minutes..

### USING YOUR COFFEE MAKER

1. Open the lid and fill the water reservoir with water. DO NOT exceed the 12-cup mark on the water gauge.
2. Place the filter into the basket (if not assembled correctly, the lid will not close).
3. Put coffee grounds into the filter (refer to the coffee label for recommended amount) and snap the lid shut.
4. Place the carafe with lid closed onto the heating plate.
5. Plug the power cord into an electrical outlet, the display will blink "12:00." Use the directions above to set the current time on the clock.
6. Set the dial to ON/OFF and press the knob once. The ON/OFF indicator will shine red and the coffee maker will begin brewing.
7. If you want to brew stronger coffee, turn the dial to STRENGTH and press one time. The indicator will shine orange. The coffee maker will begin to brew.
8. Cancel brewing at any time by turning the dial to ON/OFF and press one time. The ON/OFF indicator will extinguish and the coffee maker will shut off.

**NOTE:** While coffee is brewing, the carafe can be removed to pour a cup of coffee. The coffee maker will stop dripping automatically for 30 seconds. **Pour with caution, as the coffee is very hot!**

9. When coffee is finished brewing, remove the carafe to serve hot coffee. **Pour with caution, as the coffee is very hot!**
10. The heating plate will stay hot for 2 hours, and then shut off automatically.
11. Turn off and unplug the coffee maker when not in use.

### SETTING DELAY BREW

1. Set the clock on the coffee maker per instructions on page 6.
2. Turn the dial to PROG and press once. The ON/OFF indicator will blink green, and the display will flash 12:00.
3. To set the desired start time, turn the dial to HOUR and press the dial to set the hour (this is a 12-hour clock, so the time will show AM or PM). Turn the knob to MIN and press the dial to set the minutes..
4. After setting the desired start time, turn the dial to PROG and press once. The ON/OFF indicator will shine green. The display will show the current time.
5. When the preset time is the same as current time, the ON/OFF indicator will shine red and the coffee maker will start brewing.
6. When coffee is finished brewing, remove the carafe to serve hot coffee. **Pour with caution, as the coffee is very hot!**
7. The heating plate will stay hot for 2 hours, and then shut off automatically.
8. Turn off and unplug the coffee maker when not in use.

### DAILY CLEANING

1. Turn off and unplug the appliance.
2. Always allow the appliance to cool completely before cleaning.
3. Wash all detachable parts in hot sudsy water.
4. Wipe the heating plate and exterior of unit with a soft, damp cloth.
5. DO NOT use abrasive brushes or pads, or harsh cleaning solutions.
6. **DO NOT immerse any cord, plug or electrical appliance into water.**
7. Ensure all parts are dried thoroughly before reassembling and using this appliance.

### REMOVING MINERAL DEPOSITS

1. Calcium buildup frequently occurs in drip coffeemakers. This is normal and is caused by minerals commonly found in water. Your coffee maker will need decalcifying when you notice an obvious slow down in brewing time. We recommend decalcifying at least 4 times per year.
2. Mix 2 Tbsp. of white vinegar in 1 carafe of cold water.
3. Pour this solution into the water reservoir, close the lid and place the carafe on the heating plate.
4. Run a brewing cycle without coffee grounds (see page 6). When finished, empty the carafe and rinse it with clean water.
5. Refill the reservoir with cold water only and run another brew cycle without coffee grounds. When finished, discard the water and repeat. This will rinse out any remaining vinegar solution.

### Tips

- A clean coffee maker is essential for making great-tasting coffee. Regularly clean the coffee maker as specified in Cleaning & Care on page 8.
- Store unused coffee grounds in a cool, dry place. After opening a package, reseal it tightly and store it in a refrigerator to maintain freshness.
- For an optimum coffee taste, buy whole coffee beans and finely grind them just before brewing.
- DO NOT reuse coffee grounds.
- Reheating coffee is not recommended for optimum flavor.
- Always use fresh, cold water in the coffee maker.
- Oiliness may occur more frequently if heavily roasted coffees are used.

---

---

---

---

---

---

---

---

---

---

---

---

---

---

---

---

---

---

---

---

---

---

---

---

---

---

---

---

---

---

---

---

---

---

---

---

---

---

---

---

---

---

---

---

---

---

---

## Returns

If any item, for any reason, does not meet your expectations, just return it to us. We'll gladly either:

- Refund your merchandise amount
- Credit your account
- Send a replacement

You can return any unused item in its original packaging within 60 days of its receipt for a full refund of the purchase price (excluding shipping and handling charges).

### **Please send returns to:**

**Montgomery Ward, Inc.  
Attn: Customer Returns  
2000 Harrison Suite 100  
Clinton, IA 52732-6676**

### **When returning an item:**

- Use the original packaging and pack it securely.
- Please adequately insure your item in case you need to make a claim with the carrier you choose for returning your item.
- Include your order number and reason for return.
- We recommend keeping the receipt for 4 weeks.



## **1 Year Limited Warranty**

Montgomery Ward, Inc. warrants this Chef Tested product to be free from defects in material and workmanship for one year from provable date of purchase.

Within this warranty period, Montgomery Ward will repair or replace, at its option, defective parts of this Chef Tested product at no charge provided the product is returned freight prepaid with proof of purchase to Montgomery Ward.

Allow 2-4 weeks for return shipping.

This warranty does not cover improper installation, misuse, abuse or neglect on part of the owner. Warranty is also invalid in any case that the product is taken apart or serviced by an unauthorized service station.

This warranty gives you specific legal rights and they may vary from state to state.

THE FOREGOING WARRANTIES ARE IN LIEU OF ALL OTHER WARRANTIES AND CONDITIONS, EXPRESS OR IMPLIED, INCLUDING BUT NOT LIMITED TO THOSE OF MERCHANTABILITY OR FITNESS FOR A PARTICULAR PURPOSE.

Montgomery Ward Customer Service  
8:00 am to Midnight CST, Monday through Friday

**wards.com 1-888-557-3848**

